

BCM-2/5

Plano seccionado / Sectional drawing

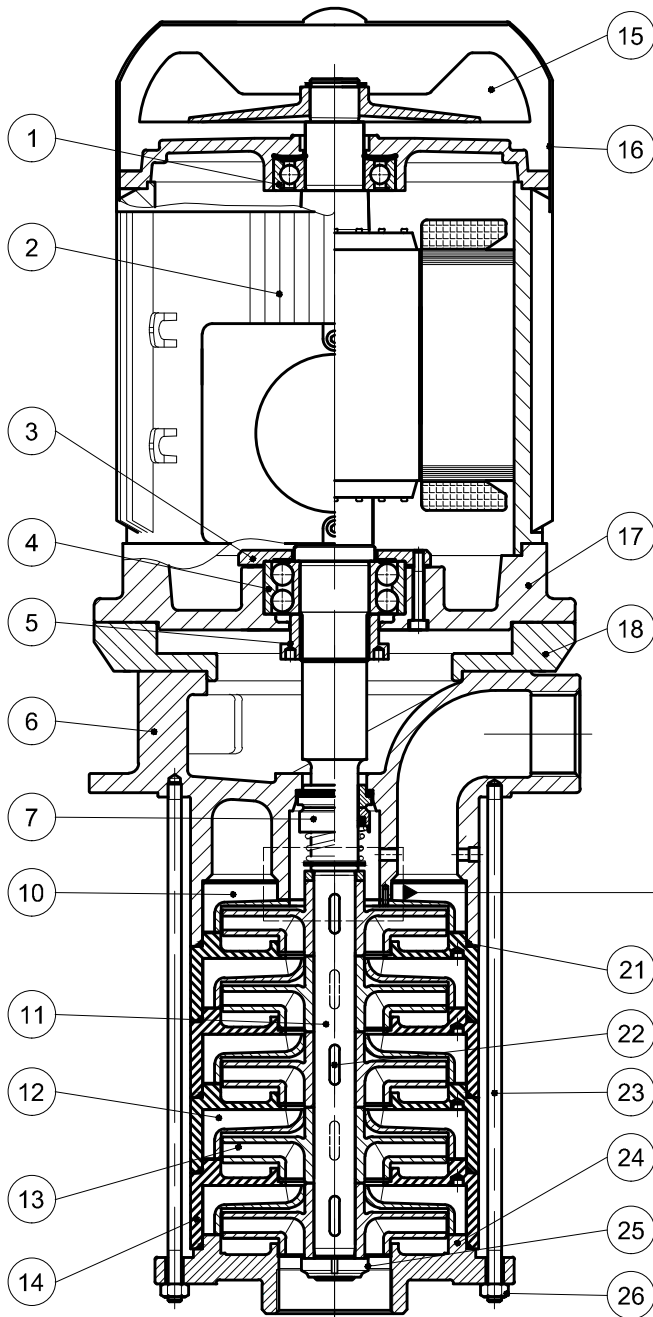

Nomenclatura / Part list

N°	Pieza / Part	Material / Material	EN / DIN
1	Rodamiento motor / Motor bearing	Acero / Steel	DIN 625
2	Motor / Motor	4,0 kW. - 2 p	-
3	Arandela sujeción rodamiento / Bearing washer	Acero / Steel	1.1191
4	Rodamiento cabeza / Head bearing	Acero / Steel	DIN 628
5	Tuerca rodamiento / Bearing nut	Acero / Steel	1.1191
6	Cuerpo / Body	Hierro fundido / Cast iron	0.6025
7	Sello mecánico / Mechanical seal	Carburo de tungsteno / Tungsten carbide	-
8	Arandela ajuste / Washer	Acero / Steel	-
9	Arandela Seeger / Seeger whaser	Acero / Steel	DIN 471
10	Difusor superior / Top Diffuser	POM / POM	-
11	Eje / Shaft	Acero / Steel	1.1191
12	Difusor / Diffuser	POM / POM	-
13	Rodete / Impeller	POM / POM	-
14	Cazoleta / Outer sleeve	Hierro fundido / Cast iron	0.6025
15	Ventilador / Fan	Poliamida 6 / Polyamide 6	PA 6
16	Caperuza / Cap	Acero / Steel	-
17	Brida motor / Motor flange	Hierro fundido / Cast iron	0.6025
18	Acoplamiento BCM-2/5 / BCM-2/5 Coupling	Hierro fundido / Cast iron	0.6025
19	Arandela separadora / Spacer washer	Acero / Steel	-
20	Pasador / Bolt	Acero / Steel	DIN 6325
21	Junta tórica / Seal joint	Nitrilo / Nitrile	-
22	Chaveta / Pin	Acero / Steel	DIN 6885
23	Varilla roscada / Threaded rod	Acero / Steel	-
24	Tapa / Bottom cover	Hierro fundido / Cast iron	0.6025
25	Tuerca / Nut	Acero / Steel	DIN 981
26	Tuerca / Nut	Acero / Steel	DIN 934

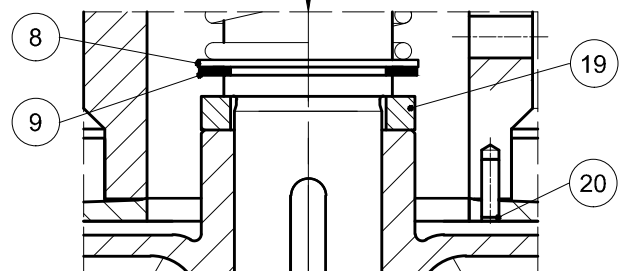

CMI, S.A.