

COMPENSATOR PLUG VALVE REGULAR PATTERN CLASS 2500 (WRENCH OPERATED)

Design Features

- Flanged Dimensions conform to ANSI/ASME B16.5, B16.34
- Butt-weld Dimensions conform to ANSI/ASME B16.25
- Threaded Dimensions conform to ANSI/ASME B 1.20.1
- Design as per API 6D
- Fire Test as per API 6FA



Figure no.	Operation	Type of ends
2511	Wrench	THREADED
2512	Wrench	RF
2513	Wrench	RTJ
2514	Wrench	WE

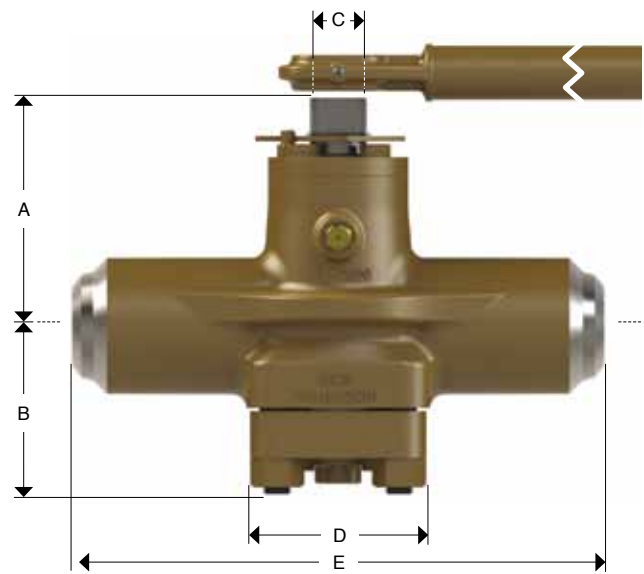
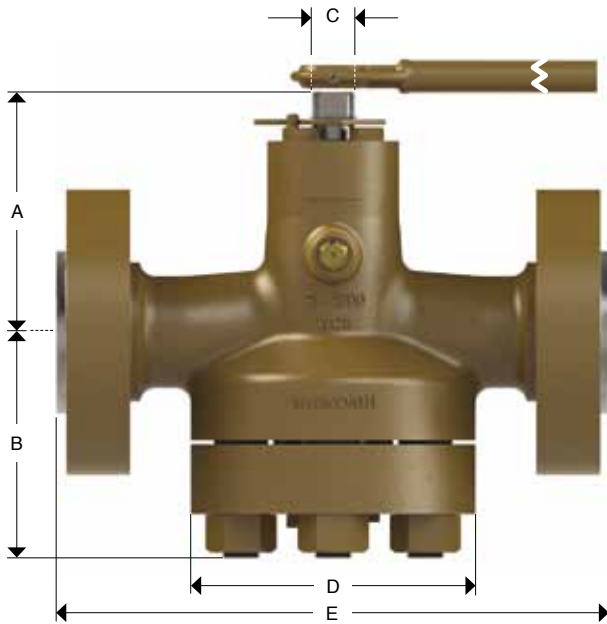

Dimensions and Weights

Nominal Size	General Dimensions										End to End Dimensions								Approx Weight						Wrench No.	
											E								RF/RTJ		WE		THREADED			
	A		B		C		D		RF		RTJ		THREADED		WE		RF/RTJ		WE		THREADED					
in	mm	in	mm	in	mm	in	mm	in	mm	in	mm	in	mm	in	mm	in	mm	Kg	lb	Kg	lb	Kg	lb	Kg	lb	
1/2	15	5.7	145	3.9	99	0.85	22	4.6	117	-	-	-	-	5.04	128	-	-	-	-	10	22	-	-	-	-	IB-0
3/4	20	5.7	145	3.9	99	0.85	22	4.6	117	-	-	-	-	5.04	128	-	-	-	-	10	22	-	-	-	-	IB-0
1	25	5.7	145	3.9	99	0.85	22	4.6	117	12.12	308	12.12	308	5.04	128	-	-	23	51	10	22	-	-	-	-	IB-0
1 1/2	40	6.6	168	4.8	122	1.09	28	7.15	182	15.12	384	15.25	387	-	-	15.12	384	40	88	-	-	30	66	-	-	IB-1
2	50	6.6	168	4.8	122	1.09	28	7.15	182	17.75	451	17.88	454	-	-	17.75	451	70	154	-	-	53	116	-	-	IB-2
3	76	8	203	5.7	145	1.41	36	8.6	218	22.75	578	23	584	-	-	22.75	578	150	330	-	-	113	248	-	-	IB-3
4	100	9.1	231	6.7	170	2.31	59	9.98	253	26.5	673	26.88	683	-	-	26.5	673	230	506	-	-	173	380	-	-	IB-3

Note: The same range of valves is available with Flanged by Butt-weld end (RF x WE) with the figure 2515

COMPENSATOR PLUG VALVE REGULAR PATTERN CLASS 2500 (GEAR OPERATED)

Regular Bill of Materials

No.	Description	Standard Material
1	Body	Carbon Steel A216 Gr. WCB
2	Plug	ASTM A 216 Gr. WCB / A395 Gr. 60-40-18
3	Cover	A515 Gr. 70
4	Stem	Stainless Steel A276 Type 410
5	Gland	A515 Gr. 70
6	Diaphragm	Stainless Steel A167 Type 304
7	Adjustment Screw	Alloy Steel A322 Gr. 4140
8	Thrust Ball	Cr. Steel Gr. 200, A295 Type 52100
9	Thrust Ball Seat	Alloy Steel AISI 4140
10	Thrust Button	Carbon Steel
11	Cover Studs	Alloy Steel A193 Gr. B7
12	Cover Stud Nuts	Carbon Steel A194 Gr. 2H
13	Gland and Cap Screw	Carbon Steel A449 Gr. 5
14	Stem Packing	Graphite
15	Balance Spring	Inconel X750
16	Stem to Plug Coupling	Alloy Steel A322 Gr. 4140
17	Plug Check Valve	Commercial Steel
18	Sealant Check Valve	Commercial Steel
19	Sealant Injection Fitting	Commercial Steel
20	Cover Gasket	Soft Steel
21	Cover Studs Environmental Seals	Buna N
22	Adjustment Cover	Carbon Steel
23	Adjustment Cover Gasket	Natural Fiber
24	Adjustment Cover Screw	Carbon Steel
25	Identification Plate*	Stainless Steel 304
26	Sealant*	Walseal #10
27	Balance Spring Ball	A295 Type 52100
28	Gear Box	Commercial Steel
29	Top Socket Screw	Carbon Steel A449 Gr. 5
30	Packing Injector	Carbon Steel

*Not Shown

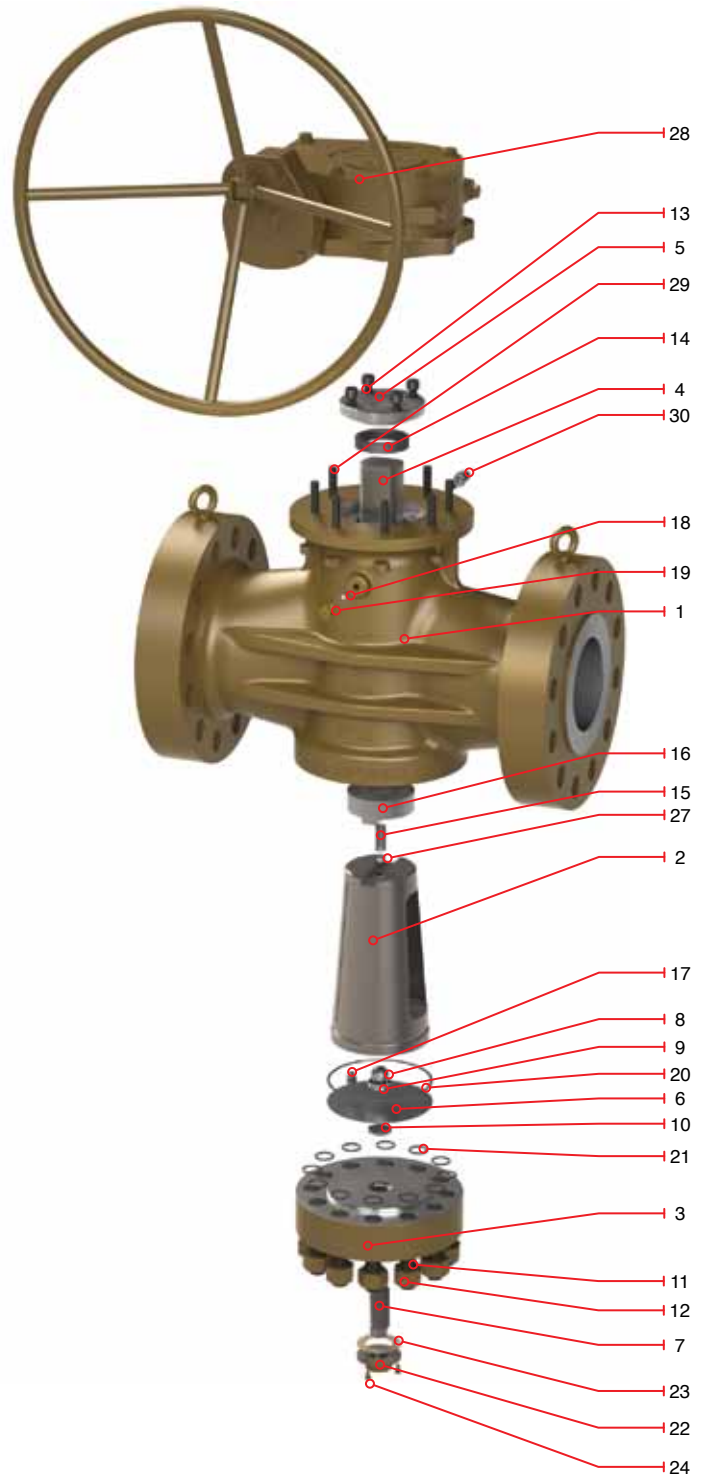

COMPENSATOR PLUG VALVE REGULAR PATTERN CLASS 2500 (GEAR OPERATED)

Design Features

- Flanged Dimensions conform to ANSI/ASME B16.5, B16.34
- Butt-weld Dimensions conform to ANSI/ASME B16.25
- Design as per API 6D
- Fire Test as per API 6FA



Figure no.	Operation	Type of ends
2522	Gear operator	RF
2523	Gear operator	RTJ
2524	Gear operator	WE

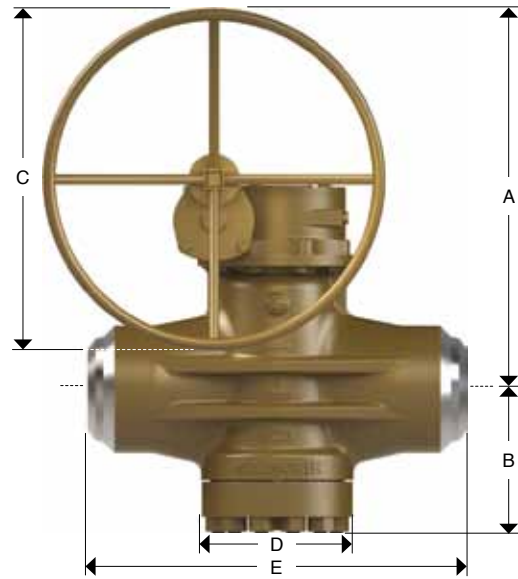
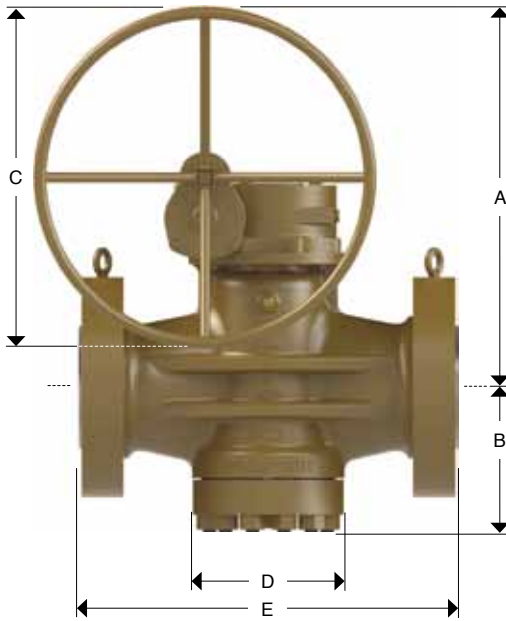

Dimensions and Weights

Nominal Size		General Dimensions								End to End Dimensions						Approx Weight			
										E						RF/RTJ		WE	
		A		B		C		D		RF		RTJ		WE					
in	mm	in	mm	in	mm	in	mm	in	mm	in	mm	in	mm	in	mm	Kg	lb	Kg	lb
6	152	17	432	9.6	244	20	508	13.5	343	36	914	36.5	927	36	914	770	1694	578	1271
8	203	19.5	495	11.8	300	30	762	17.8	452	40.25	1022	40.88	1038	40.25	1022	1013	2229	760	1671

Note: The same range of valves is available with Flanged by Butt-weld end (RF x WE) with the figure 2525