

## CPT4 HIGH PRESSURE WATER PUMP

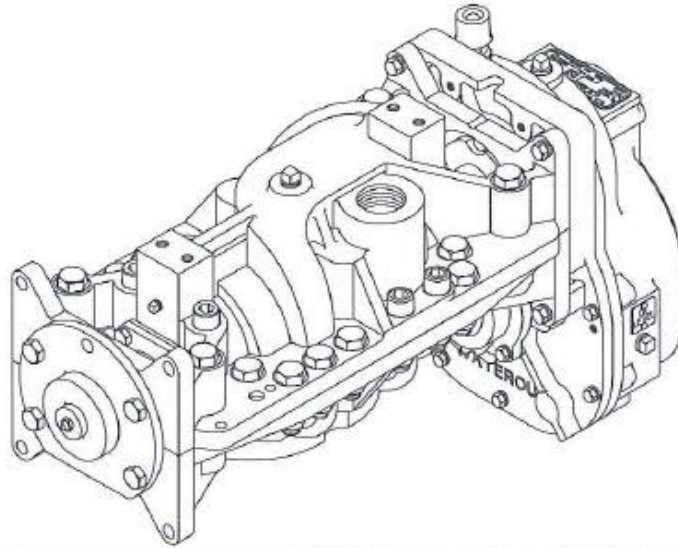

IL 1596

### Description

This ultra high-pressure performer is a lightweight four-stage centrifugal pump that delivers 60 gpm (227 l/m) at 1000 psi (69 bar) to produce high-pressure fog which can knock out fires quickly while the pumper is either in motion or stationary.

The many features of the Waterous CP-4 pump make it ideal where high-pressure pump performance is required.

The CP-4 can be used either as an auxiliary pump to provide "booster" service on an apparatus that also has a rated midship pump, or as the only pump on a mini-pumper, brush truck or other special purpose vehicle. Especially adaptable to "pump and roll" operation, the CP-4 pump will supply two or more high-pressure booster reels with ultra-high pressure. Ideal for situations where a limited water supply is available and a high pressure fog is desirable for knocking out a fire quickly before it spreads.

Its compact lightweight design and variety of transmission options permit the CP-4 to be mounted on a fully equipped pumper or tanker without requiring excessive space or overloading the chassis. Used this way, the CP-4 becomes an important part of a versatile fire-fighting unit.

The Waterous CP-4 pumps has been carefully engineered and each one is thoroughly tested before shipment. The pump incorporates an integral speed increasing transmission and various gear ratios are available to suit your application.

Quality construction features include quiet, cool-running helical gears; replaceable wear rings; balanced impellers; and grease or oil lubricated, anti-friction bearings supporting both ends of the impeller shaft and drive shaft.

Because the dependable CP-4 pump has been designed with versatility in mind, and each unit is custom built to fit your particular requirements, it is best to check with a builder of Waterous-equipped apparatus to determine the top performance of this combination with the chassis, engine, and transmission of your choice.

### Pump/Transmission Specifications

#### Casings:

Two-piece, horizontally split high tensile, close-grained, gray iron (bronze optional).

#### Wear Rings:

Ni-resist; special "stepped" design to reduce internal leakage and increase efficiency. Replaceable by undersize rings to prolong pump life and minimize maintenance costs.

#### Impellers:

Bronze, hydraulically and mechanically balanced – one integrally cast pair for the first and second stages and another for the third and fourth stages. Impeller hubs are "stepped" to minimize internal bypass.

#### Stuffing Boxes:

Square graphited rings of Grafoil<sup>®</sup> packing held in place by a split bronze gland which is fully removable and adjustable. Grafoil<sup>®</sup> packing is a pure graphite packing which improves heat dissipation, reduces maintenance and facilitates negligible shaft wear.

#### Rotation:

Available with either clockwise or counter-clockwise rotation of input shaft.

#### Bearings:

All bearings are oil or grease lubricated, anti-friction (ball type), located outside the pump casing to accurately align and support the impeller shaft assembly. Ball bearings are deep groove type designed to carry both radial and axial thrust.

#### Intake:

2" (5 cm) NPT

#### Discharge:

1-1/2" (3.8 cm) NPT



# IW Series

## CPT4 HIGH PRESSURE WATER PUMP

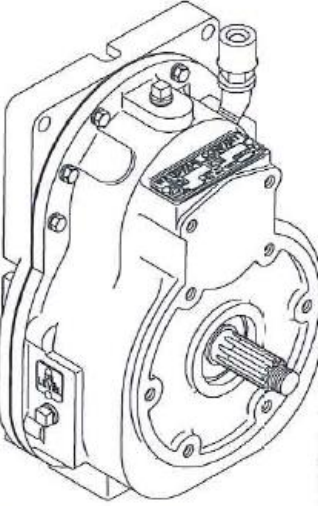
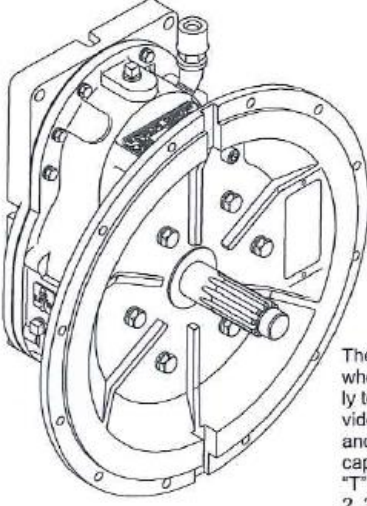

 <p style="text-align: right; margin-right: 20px;">IL 1526</p> <p>The "K" series transmission is normally used when a truck transmission mounted power take-off is selected as the pump drive.</p>	 <p style="text-align: right; margin-right: 20px;">IL 1529</p> <p>The "T" series transmission is supplied when the pump is to be mounted directly to the engine bell housing. This provides a clean, compact arrangement and allows for complete pump and roll capability. "T" transmissions are available in SAE 2, 3, 4, or 5 bell housing adapters.</p>
--	---

Transmissions are available in the following ratios: 1.62, 1.97, 2.14, 2.55, 2.79, 3.40, 4.00, 4.79

### Accessories & Optional Equipment

**Primer:**

Select either the Waterous electric rotary-gear or vane-type primer for fast reliable priming. Choice of push-button or manual-electric priming valves. See priming systems specification F-1175.

**Drain Valve:**

Manifold drain valve simultaneously drains all points of the pump by operating a single control. See specification F-1158.

NOTE: Specifications subject to change without notice.

### Dimensions and Weights

Table 1. Approximate Dimensions and Weights

Measurement	Length		Width		Height		*Weight	
	CPK-4	CPT-4	CPK-4	CPT-4	CPK-4	CPT-4	CPK-4	CPT-4
US <sup>1</sup>	28.438	32.500	10.750	17.750	15.250	18.250	300	300
Metric <sup>2</sup>	72.2	82.5	27.3	45.1	38.7	46.4	136	136

\*Includes oil

<sup>1</sup>US measurements in inches and pounds  
<sup>2</sup>Metric measurements in centimeters and kilograms

**TRANSLINK** International Sales Ltd.,

The Pigpen, Mill Farm, Farlow, Kidderminster, Worcestershire, DY14 0LP. UK  
Tel : +44 (0)1746 718 740 Fax : +44 (0) 1746 718 540 e-mail : [translink-international@dial.pipex.com](mailto:translink-international@dial.pipex.com)

[www.translink-international.com](http://www.translink-international.com)