

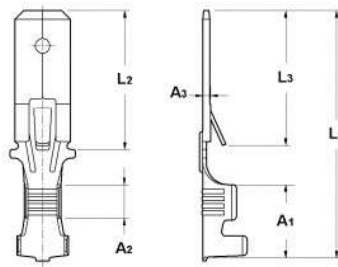

## WIRE CRIMP TABS 6,3 FOR MULTI-WAY CONNECTIONS (WITH LOCKING LANCE)



WIRE SIZE (mm <sup>2</sup> )	0,25 ÷ 0,75 (AWG 23-18)
INSULATION (mm)	1,5 ÷ 2,2
MATING TAB THK (mm)	0,80
STOCK THK (mm)	0,38
<b>P</b>	Si
<b>Q</b>	No
A1	8.20
A2	4.50
3	0.90

I1	28.00	Scroll right to navigate table >
 <b>Inarca</b>	15.70	
L3	15.30	
PN	0011546201	
<b>BASE MATERIAL</b>	CuZn	
<b>PLATING MATERIAL</b>	Tin Plated	
<b>PACKING UNIT REEL</b>	6000	
<b>PACKAGING QTY</b>	24000	

